

# MIG TORCH

焊接配件MIG系列

## AUTO MIG 25



Technical data	技术参数
Cooling 冷却方式	Gas Cooled 气冷
Duty cycle 60% 暂载率60%	230Amp CO <sub>2</sub> , 200Amp MIX
Wire Size 焊丝直径	Φ0.8-1.2mm

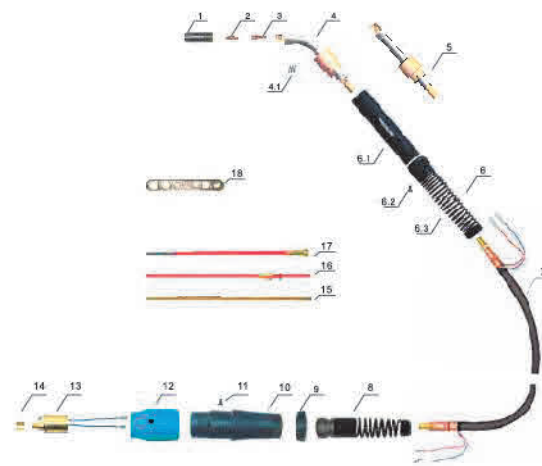

Position	Ref.	Description
1	145.0076	Gas nozzle Φ 15mm; 喷嘴 Φ 15mm
2	140.0242	Contact tip Φ 1.0mm E-CU/M6x28; 导电嘴 Φ 1.0mm/M6x28mm
3	142.0001	Gas Diffuser M6x35; 分流器 M6x35 25AK
4		Torch head auto 25AK 45°; 自动枪头 25AK 45°
4.1	003.0013	spring 25AK; 弹簧 25AK
5		Torch head auto 25AK 0°; 自动枪头 25AK 0°
6		Handle for auto MIG torch; 手柄套件MIG自动枪头用
6.1		Handle for auto MIG torch; 手柄MIG自动枪头用
6.2		Screw M4x8; 螺丝 M4x8
6.3		Spring for cable support; 电缆支撑弹簧
7		Coaxial cable 3m; 同轴电缆组/3m
8		Joint with spring; 带弹簧球节
9		Handle closing ring; 手柄锁紧环
10		Back box; 后把套
11		Screw M4x6; 螺丝 M4x6
12		Adaptor nut/Blue; 焊枪锁紧螺母/蓝色
13	501.2155	Euro central adaptor body/air cooling; 欧式中央接头/空冷
14	501.0082	Liner nut; 送丝管锁紧螺母
15		Brass terminal Φ 2.0x4.0mm 0.35m; 铜送丝管 Φ 2.0x4.0mm/0.35m
16	126.0021	Teflon liner Φ 2.0x4.0mm 3m Red; 特氟龙管 Φ 2.0x4.0mm/3m/红色
17	124.0026	Red liner Φ 1.0-1.2mm 3m; 带绝缘层送丝管 Φ 1.0-1.2mm/3m/红色
18		Spanner for MIG torches; MIG 焊枪扳手
Complete Torch		Torch auto MIG25AK 0° 3m euro adaptor/spring pins 自动焊枪25AK/0° /3m/弹性针
		Torch auto MIG25AK 45° 3m euro adaptor/spring pins 自动焊枪25AK/45° /3m/弹性针

Note: about the registered trade mark, reference number used are only for convenient research. we are no way affiliate with mentioned registered trade marks and brand

# MIG TORCH

焊接配件MIG系列

## AUTO MIG 36



Technical data	技术参数
Cooling 冷却方式	Gas Cooled 气冷
Duty cycle 60% 暂载率60%	300Amp CO <sub>2</sub> , 270Amp MIX
Wire Size 焊丝直径	Φ0.8-1.6mm



Position	Ref.	Description
1	145.0078	Gas nozzle Φ 16mm; 喷嘴 Φ 16mm 36KD
2	140.0379	Contact tip Φ 1.2mm E-CU/M6x28; 导电嘴 Φ 1.2mm/M6x28mm
3	142.0011	Contact tip holder M6x32mm; 导电嘴座36KD/M6x32mm
4	014.0023	White ceramic gas diffuser; 白色陶瓷分流器 36KD
5		Torch head auto 36KD 45°; 自动枪头 36KD 45°
6		Torch head auto 36KD 0°; 自动枪头 36KD 0°
7		Handle for auto MIG torch; MIG自动枪头用手柄套件
7.1		Handle for auto MIG torch; 手柄MIG自动枪头用
7.2		Screw M4x8; 螺丝 M4x8
7.3		Spring for cable support; 电缆支撑弹簧
8		Coaxial cable 3m; 同轴电缆组/3m
9		Joint for MIG handle; MIG手柄用球头
10		Handle closing ring; 手柄锁紧环
11		Back box; 后把套
12		Screw M4x6; 螺丝 M4x6
13		Adaptor nut/Blue; 焊枪锁紧螺母/蓝色
14	501.2155	Euro central adaptor body/air cooling; 欧式中央接头/空冷
15	501.0082	Liner nut; 送丝管锁紧螺母
16		Brass terminal Φ 3.0x4.5mm 0.35m; 铜送丝管 Φ 3.0x4.5mm/0.35m
17	126.0039	Teflon liner Φ 3.0x4.5mm 3m Yellow; 特氟龙管 Φ 3.0x4.5mm/3m/黄色
18	124.0041	Yellow liner Φ 1.2-1.6mm 3m; 带绝缘层送丝管 Φ 1.2-1.6mm/3m/黄色
19		Spanner for MIG torches; MIG 焊枪扳手
Complete Torch		Torch auto MIG36KD 0° 3m euro adaptor/spring pins; 自动焊枪36KD/0° /3m/弹性针
		Torch auto MIG36KD 45° 3m euro adaptor/spring pins; 自动焊枪36KD/45° /3m/弹性针

Note: about the registered trade mark, reference number used are only for convenient research. we are no way affiliate with mentioned registered trade marks and brand



# MIG TORCH

焊接配件MIG系列

## AUTO MIG 240



Technical data	技术参数
Cooling 冷却方式	Gas Cooled 气冷
Duty cycle 60% 负载率60%	180Amp CO <sub>2</sub> , 150Amp MIX
Wire Size 焊丝直径	Φ0.6-1.0mm

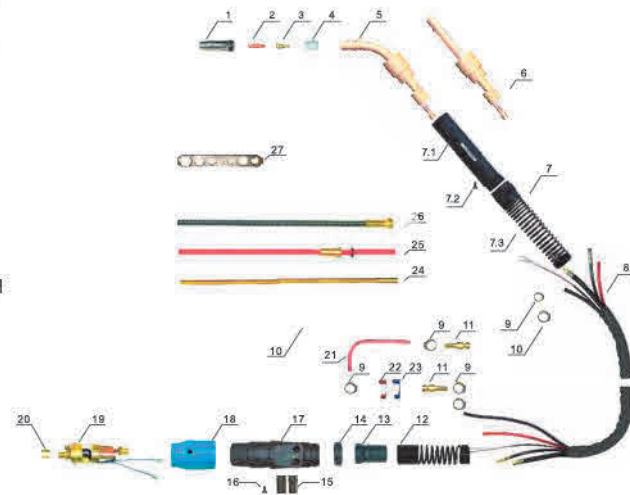

Position	Ref.	Description
1	145.0080	Gas nozzle Φ 12.5mm; 喷嘴Φ 12.5mm
2	140.0253	Contact tip Φ 1.0mm E-CU/M6x25; 导电嘴Φ 1.0mm/M6x25mm
3	142.0003	Contact tip holder M6x26mm; 导电嘴座24KD/M6x26mm
4		White ceramic gas diffuser; 白色陶瓷分流器 24KD
5		Torch Head auto 240 45°; 自动枪头 240 45°
6		Torch head auto 240 0°; 自动枪头 240 0°
7		Spring cable support for torch auto; 自动枪用电缆支撑用弹簧
7.1		Handle for auto MIG torch; 手柄MIG自动枪颈用
7.2		Screw M4x8; 螺丝 M4x8
7.3		Spring for cable support; 电缆支撑弹簧
8		Cable assembly 3m 401D-501D; 水冷电缆组 3m 401D-501D
9	171.0002	Clamp Φ 8.7; 卡箍Φ 8.7
10	173.0001	Clamp Φ 9.5; 卡箍Φ 9.5
11	501.0114	Quick connector water Φ 6; 水冷快速插头Φ 6mm
12		Spring cable support 401D-501D; 电缆支撑用弹簧 401D-501D
13		Joint for MIG handle; MIG 手柄用球头
14		Handle closing ring; 手柄项紧环
15		Hose support for water cooled rear box; 水冷枪后把套用水管支柱
16		Screw M4x6; 螺丝 M4x6
17		Back box for water cooled; 水冷枪后把套
18		Adaptor nut/Blue; 焊枪锁紧螺母/蓝色
19	501.2156	Euro central adaptor body/water cooling; 欧式水冷中央接头/水冷
20	501.0082	Liner nut; 送丝管锁紧螺母
21		Output water tube M5x8mm 0.8m red; EPDM 编织管 M5x8mm 0.8m/红色
22		Plastic support for water cooling connector /red; 水堵/红色
23		Plastic support for water cooling connector /blue; 水堵/蓝色
24		Brass terminal Φ 2.0x4.0mm 0.35m; 铜送丝管Φ 2.0x4.0mm/0.35m
25	126.0005	Teflon liner Φ 2.0x4.0mm 3m Red; 特氟龙管Φ 2.0x4.0mm/3m/红色
26	122.0031	Steel liner Φ 1.0-1.2mm 3m; 钢送丝管Φ 1.0-1.2mm/3m
27		Spanner for MIG torches; MIG 焊枪扳手
Complete Torch		
		Torch auto MIG 240 0° 3m euro adaptor /spring pins 自动焊枪240 0° /3m 弹性针
		Torch auto MIG 240 45° 3m euro adaptor /spring pins 自动焊枪240 45° /3m 弹性针

Note: about the registered trade mark, reference number used are only for convenient research. we are no way affiliate with mentioned registered trade marks and brand

# MIG TORCH

焊接配件MIG系列

## AUTO MIG 500



Technical data	技术参数
Cooling 冷却方式	Gas Cooled 气冷
Duty cycle 60% 负载率60%	180Amp CO <sub>2</sub> , 150Amp MIX
Wire Size 焊丝直径	Φ0.6-1.0mm

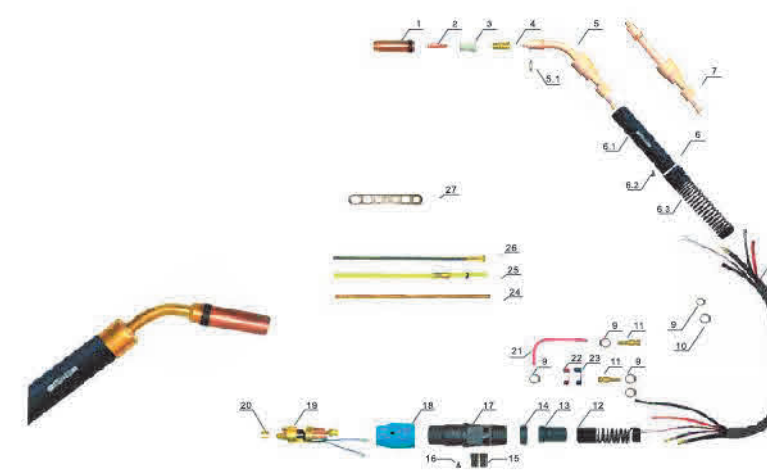

Position	Ref.	Description
1	145.0085	Gas nozzle Φ 16mm; 喷嘴Φ 16mm 401D-501D
2	140.0442	Contact tip Φ 1.2mm E-CU/M8x30; 导电嘴Φ 1.2mm/M8x30mm
3	030.0190	White ceramic gas diffuser; 白色陶瓷分流器 401D-501D
4	142.0022	Contact tip holder M8x25mm; 导电嘴座 M8x25mm 401D-501D
5		Torch Head auto 501D 45°; 自动枪头 501D 45°
5.1	030.0019	Insulator 401D-501D; 绝缘垫片 401D-501D
6		Handle for auto MIG torch; MIG 自动枪颈用手柄
6.1		Handle for auto MIG torch; 手柄MIG自动枪颈用
6.2		Screw M4x8; 螺丝 M4x8
6.3		Spring for cable support; 电缆支撑弹簧
7		Torch Head auto 501D 0°; 自动枪头 501D 0°
8		Cable assembly 3m 401D-501D; 水冷电缆组 3m 401D-501D
9	171.0002	Clamp Φ 8.7; 卡箍Φ 8.7
10	173.0001	Clamp Φ 9.5; 卡箍Φ 9.5
11	501.0114	Quick connector water Φ 6mm; 水冷快速插头Φ 6mm
12		Spring cable support 401D-501D; 电缆支撑用弹簧 401D-501D
13		Joint for MIG handle; MIG 手柄用球头
14		Handle closing ring; 手柄项紧环
15		Hose support for water cooled rear box; 水冷枪后把套用水管支柱
16		Screw M4x6; 螺丝 M4x6
17		Back box for water cooled; 水冷枪后把套
18		Adaptor nut; 焊枪锁紧螺母
19	501.2156	Euro central adaptor body/water cooling; 欧式水冷中央接头/水冷
20	501.0082	Liner nut; 送丝管锁紧螺母
21		Output water tube M5x8mm 0.8m red; EPDM 编织管 M5x8mm 0.8m/红色
22		Plastic support for water cooling connector /red; 水堵/红色
23		Plastic support for water cooling connector /blue; 水堵/蓝色
24		Brass terminal Φ 3.0x4.5mm 0.35m; 铜送丝管Φ 3.0x4.5mm/0.35m
25	126.0039	Teflon liner Φ 3.0x4.5mm 3m Yellow; 特氟龙管Φ 3.0x4.5mm/3m/黄色
26	122.0056	Steel liner Φ 1.2-1.6mm 3m; 钢送丝管Φ 1.2-1.6mm/3m
27		Spanner for MIG torches; MIG 焊枪扳手
Complete Torch		
		Torch auto MIG 501D 0° 3m euro adaptor /spring pins; 自动焊枪501D 0°/3m 弹性针
		Torch auto MIG 501D 0° 4m euro adaptor /spring pins; 自动焊枪501D 0°/4m 弹性针
		Torch auto MIG 501D 0° 5m euro adaptor /spring pins; 自动焊枪501D 0°/5m 弹性针
		Torch auto MIG 501D 45° 3m euro adaptor /spring pins; 自动焊枪501D 45°/3m 弹性针
		Torch auto MIG 501D 45° 4m euro adaptor /spring pins; 自动焊枪501D 45°/4m 弹性针
		Torch auto MIG 501D 45° 5m euro adaptor /spring pins; 自动焊枪501D 45°/5m 弹性针

Note: about the registered trade mark, reference number used are only for convenient research. we are no way affiliate with mentioned registered trade marks and brand